

LED 1W



- **Product Description**

Quick Details

Type: High Power LED

Chip Material: InGaN

Emitting Color: Purple Red Blue Green Cyan Yellow White

Luminous Intensity: 365nm-940nm

Luminous Flux(lm): 100lm/w

Optical Attenuation(%): 1

Power: 1W

Power Dissipation: 50000

Viewing Angle(°): 140 Degree

Color Rendering Index(Ra): 85

Color Temperature: 2800-7000k

Operating Temperature(°C): -20 - 200

Storage Temperature(°C): -40 - 120

Place of Origin: Guangdong, China (Mainland)

Wavelength: 365nm-940nm

Voltage: 1.2-3.4V

Warranty: 2 Years

Chip Size: 30mil

Application: Indoor/outdoor Light

Forward Current: 300-350mA

Our advantages

1. Less power consumption: light effects to 75lm/w of the LED power consumption than equivalent incandescent brightness reduced by 80%.
2. Long life: product life of up to 50,000 hours.
3. Nanosecond response time, brightness and color make it easy to dynamically control: enables dynamic color changes and digital control.
4. A large design space: the organic architecture can be realized with the integration to only see the effect of light not seen light.
5. Environmental protection: no toxic metals mercury, no infrared and ultraviolet radiation.
6. Color: different wavelengths produce different colored light, bright saturated, no filter, can control red, green and blue primary colors to form a variety of colors, can realize full-color gradients, and other color effects.

Product Description

| Color | WL(nm)/CCT(K) | Lumens(LM) | Chip Size | Chip Brand | Chip Quantity (pcs) | Input volt(V) | Input current (mA) |
|--------|--|------------|---------------------|--------------------------|---------------------|---------------|--------------------|
| Purple | 365-445 nm | 30-60 | 30mil, 42mil, 45mil | Epileds, Epistar | 1 | 3.0-3.4 | 300-600 |
| Red | 620-660 nm, 730-740 nm, 940-950 nm, 850 nm | 50-90 | 38mil, 40mil, 42mil | Epileds, Epistar | 1 | 2.0-2.4 | 300-600 |
| Blue | 445-470 nm | 60-120 | 30mil, 35mil, 45mil | Epistar, Bridgelux, Cree | 1 | 3.0-3.4 | 300-600 |
| Green | 510-530 nm | 80-130 | 40mil | Epileds | 1 | 3.0-3.4 | 300-600 |
| Cyan | 495-500 nm | 70-90 | 40mil | Epileds | 1 | 2.0-2.4 | 300-600 |
| Yellow | 585-595 nm | 70-90 | 38mil, 40mil | Epileds | 1 | 2.0-2.4 | 300-600 |
| White | 2700-20000 K | 100-160 | 30mil, 35mil, 45mil | Epistar, Bridgelux, Cree | 1 | 3.0-3.4 | 300-600 |

The Structure Design Picture

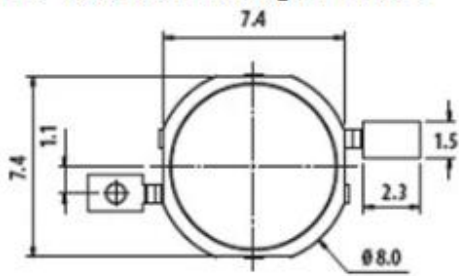

TOP VIEW

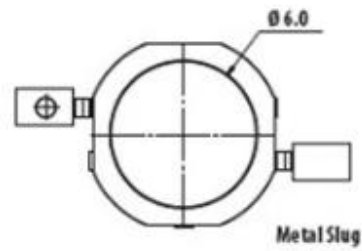

BOTTOM VIEW

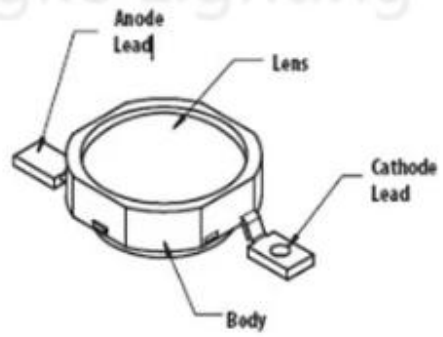
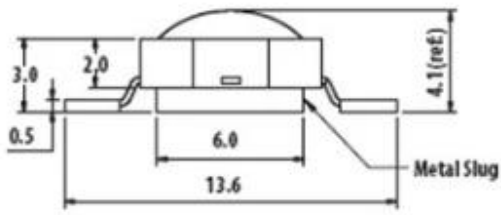

Dongguan Hongke Lighting