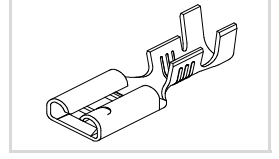

FEMALE TERMINALS**TD 2107****Description/Tanım**

MINI DİŞİ FİŞ 4.8

**Wire section range**0.50 - 1.00 mm²

Kablo kesit aralığı

Materials & Temperature

Malzeme ve Sıcaklıkları

Part no	Material	Coating	Max. Temp. (°C)
Ürün no	Malzeme	Kaplama	Max. Sıcaklık
TD 2107 RP	Brass / Pirinç	Naturel	110
TD 2107 RPK	Brass / Pirinç	Tin	120
TD 2107 RÇN	Steel / Çelik	Nickel/Nikel	300

Note : Temperatures as per IEC 61210 standard.

Material thickness

0,30 - 0.35 mm

Malzeme kalınlığı

Crimping parameters & Pull-out force

Sıkma parametreleri ve Çekme kuvveti

Wire section (mm ² ±10%) Kablo kesiti	Conductor (±0.03) İletken		Insulator (±0.10) Yalıtkan	Pull-out force (N) Çıkma kuvveti
	Height/Yüks.(mm)	Width/Gen.(mm)	Width/Gen. (mm)	MESA min.
0,50	1,20	2,10	3,11	56
0,75	1,30	2,11	3,13	84
1,00	1,40	2,12	3,14	108

Note : Values only valid for the application tool specified upwards. The insulator widths are only indicative as they are dependent on the sheath thickness of the wire used

Packaging

Ambalaj

10.000 pcs /

Wide cardboard reel.

Pitch

Hatve

17,10 mm

Drawing

Çizim

Approvals

Onaylar

- RoHS Compliant

- REACH

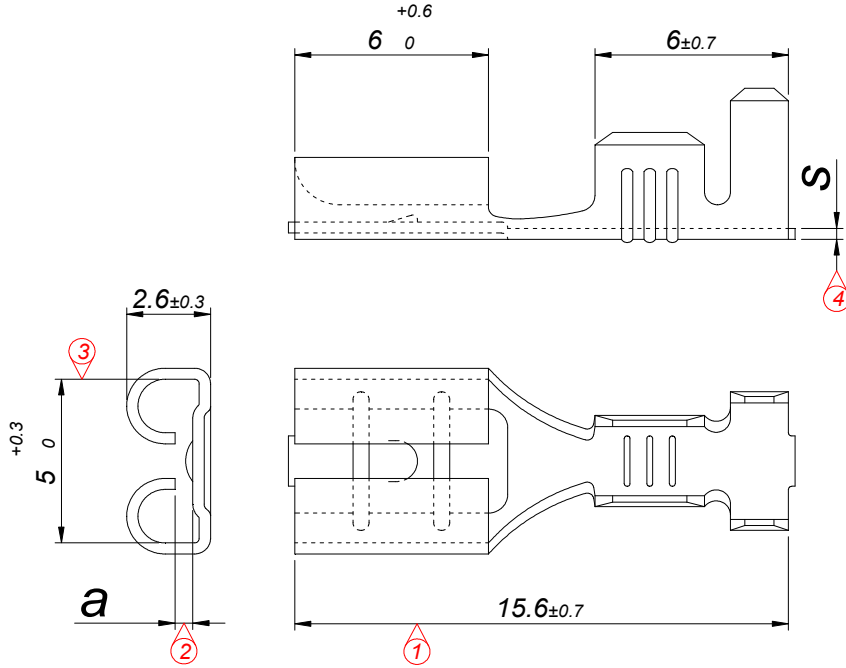

Rev. No	Revision/Revizyon
00	
01	