

16/19/22MM metal button switch waterproof with LED light self-locking reset circular jog start switch

Specifications

Contact type : 3NO

color : multicolor

Backlight color : multicolor

Rated voltage V : DC 220V

Rated current A : 5A

Conventional heating current : 6A

Operating frequency : 50/60HZ

Number of buttons : 1

Head shape : Round

Protection function : water proof

Application range : medical products

Wiring : Welding/connector

Mechanical life : 50,000 times

Electrical life : 50,000 times

Operating temperature : -30~100°C

shell material : Stainless steel

certified productce

degree of protection : IP65

Contact material : silver contact

Product Series : metal button

rated voltage range : Below 220V

Expand parameters

All 15 specifications and models

model	contact type	color	Backlight color	Rated voltage	rated current		operating frequency	operating structure	Dimensions	installation size	switch type
				(V)	(A)						
16MM self-reset without light	3NO	multicolor	multicolor	DC 220V	5A	6A	50/60HZ	self reset	Hole 16mm	15*15mm	Self-locking
16MM reset with light	3NO	multicolor	multicolor	DC 220V	5A	6A	50/60HZ	self reset	Hole 16mm	15*15mm	Self-locking
16MM self-locking without light	3NO	multicolor	multicolor	DC 220V	5A	6A	50/60HZ	1 bit lock + 1 bit automatic return	Hole 16mm	15*15mm	Self-locking
16MM self-locking with light	3NO	multicolor	multicolor	DC 220V	5A	6A	50/60HZ	1 bit lock + 1 bit automatic return	Hole 16mm	15*15mm	Self-locking
16MM connector	3NO	multicolor	multicolor	DC 220V	5A	6A	50/60HZ	self reset	Hole 16mm	15*15mm	Self-locking
19MM self-reset without light	3NO	multicolor	multicolor	DC 220V	5A	6A	50/60HZ	self reset	16*19*2 2mm	15*15mm	Self-locking
19MM self-resetting with light	3NO	multicolor	multicolor	DC 220V	5A	6A	50/60HZ	self reset	16*19*2 2mm	16*19*22	button
19MM self-locking without light	3NO	multicolor	multicolor	DC 220V	5A	6A	50/60HZ	1 bit lock + 1 bit automatic return	16*19*2 2mm	16*19*22	button
19MM self-locking with light	3NO	multicolor	multicolor	DC 220V	5A	6A	50/60HZ	1 bit lock + 1 bit automatic return	16*19*2 2mm	16*19*22	button
19MM connector	3NO	multicolor	multicolor	DC 220V	5A	6A	50/60HZ	1 bit automatic return + 1 bit key release	16*19*2 2mm	16*19*22	button
22MM reset without light	3NO	multicolor	multicolor	DC 220V	5A	6A	50/60HZ	self reset	16*19*2 2mm	16*19*22	button
22MM self-locking without light	3NO	multicolor	multicolor	DC 220V	5A	6A	50/60HZ	1 bit lock + 1 bit automatic return	16*19*2 2mm	16*19*22	button
22MM reset with light	3NO	multicolor	multicolor	DC 220V	5A	6A	50/60HZ	self reset	16*19*2 2mm	16*19*22	button
22MM self-locking with light	3NO	multicolor	multicolor	DC 220V	5A	6A	50/60HZ	1 bit lock + 1 bit automatic return	16*19*2 2mm	16*19*22	button
22MM connector	3NO	multicolor	multicolor	DC 220V	5A	6A	50/60HZ	self reset	16*19*2 2mm	16*19*22	button

model

model
16MM self-reset without light
16MM reset with light
16MM self-locking without light
16MM self-locking with light
16MM connector
19MM self-reset without light
19MM self-resetting with light
19MM self-locking without light
19MM self-locking with light
19MM connector
22MM reset without light
22MM self-locking without light
22MM reset with light
22MM self-locking with light
22MM connector

product description



可定制图案颜色详情客服

8/10/12/16/19/22/25金属按钮开关



产品参数

按钮直径	8/10/12/16/19/22MM	额定电流	3-5A
操作类型	自复位/自锁	防水等级	IP65
触点类型	1NO 1NC/2NO 2NC	头部形状	高头/平头
外壳材质	铜镀镍/不锈钢	接线方式	焊接脚
基座材质	PA66增强尼龙	环境温度	-25° C~+55°
光源类型	环形灯/电源灯	绝缘电阻	≥100
电气寿命	20W以上	机械寿命	70W次以上
灯光颜色	红/黄/蓝/绿/白		

具体详情请咨询客服

乐清市鸿怡电气厂
shop0919087950352.1688.com

12mm

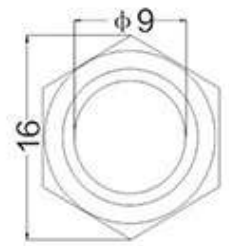
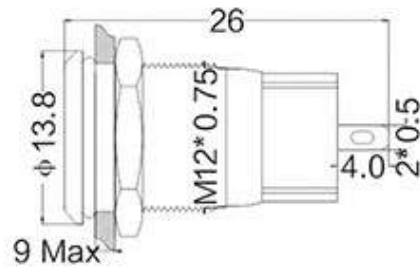

16mm

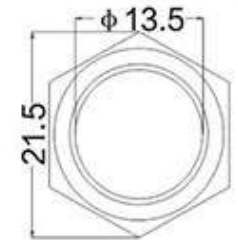
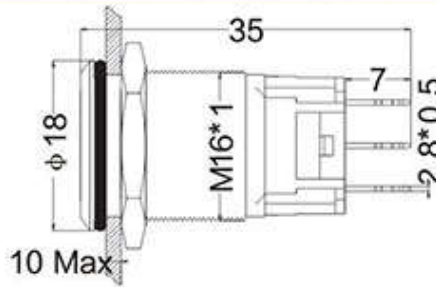
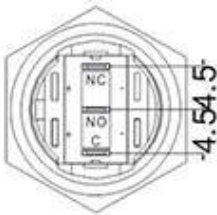

19mm

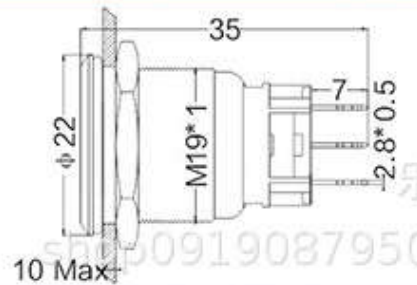
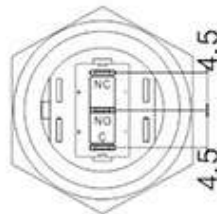

乐清市鸿怡电气有限公司
0919087950352.1688.com

22mm

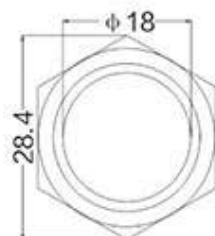
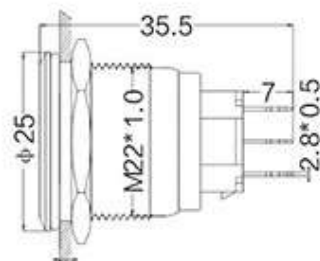
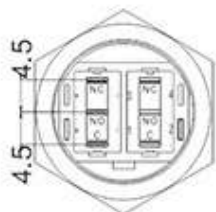

25mm

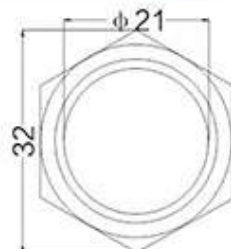
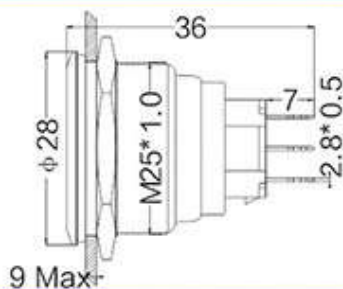
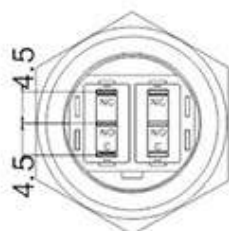

30mm

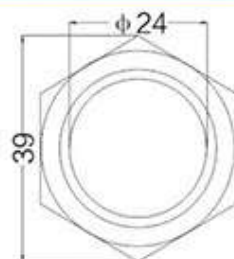
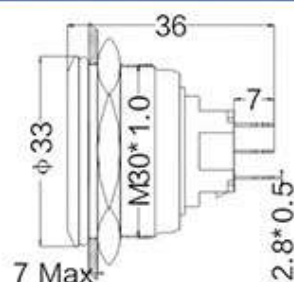
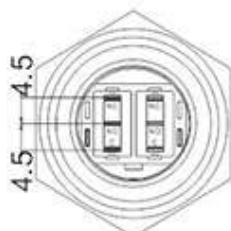

温馨提示：
接线时请注意用电安全
建议选购本店优质插壳进行接线

乐清市鸿怡电气厂

shop0919087950352.1688.com

接线方式



12mm颜色说明:

红色: LED灯正极

黑色: LED灯负极

蓝色: 常开脚，按下去两根蓝色线通电

12mm接线说明：按下负载通电，按键灯亮

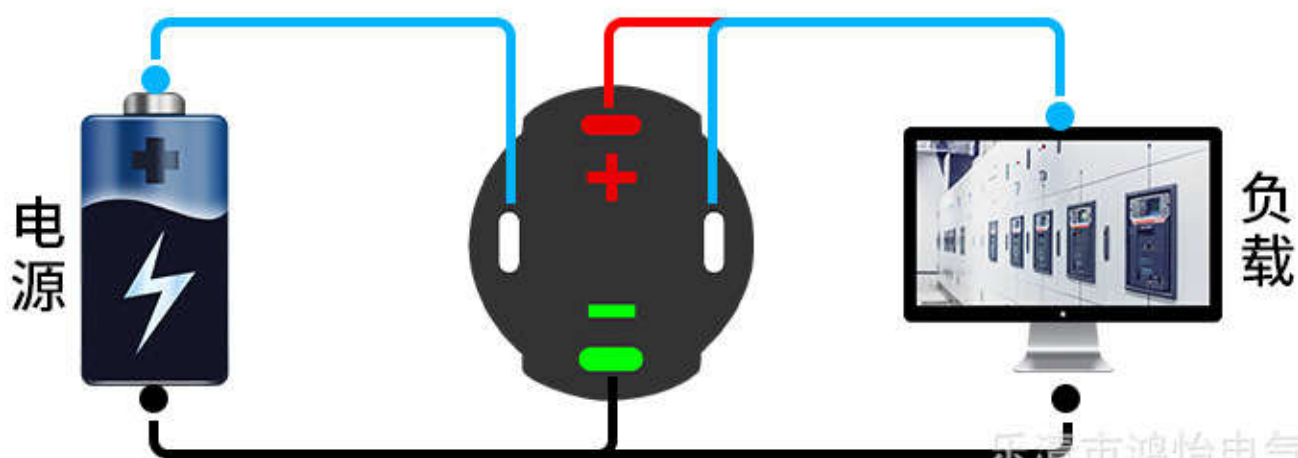

乐清市鸿怡电气有限公司

shop0919087950352.1688.com

16mm~30mm颜色说明:

红色: LED灯正极

黑色: LED灯负极

绿色: 触点公共脚

蓝色: 常开脚, 按下去和绿色线通电

黄色: 常闭脚, 按下去和绿色线断电(一般不接)

接线说明: 按下负载通电, 按键灯亮

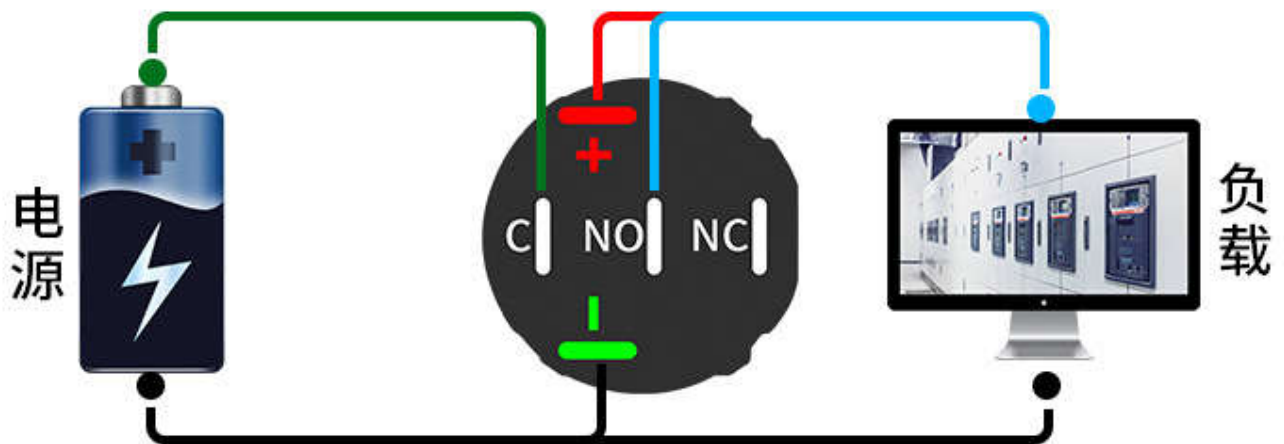

乐清市鸿怡电气有限公司

shop0919087950352.1688.com

铜件银点

加大加厚银触点
解除可靠，使用寿命长



乐清市鸿怡电气厂
shop0919087950352.1688.com

IP66防水等级

头部防水，防尘阻燃



乐清市鸿怡电气厂
shop0919087950352.1688.com

12/16/19/22mm

金属按钮开关

防水防尘·耐高温阻燃

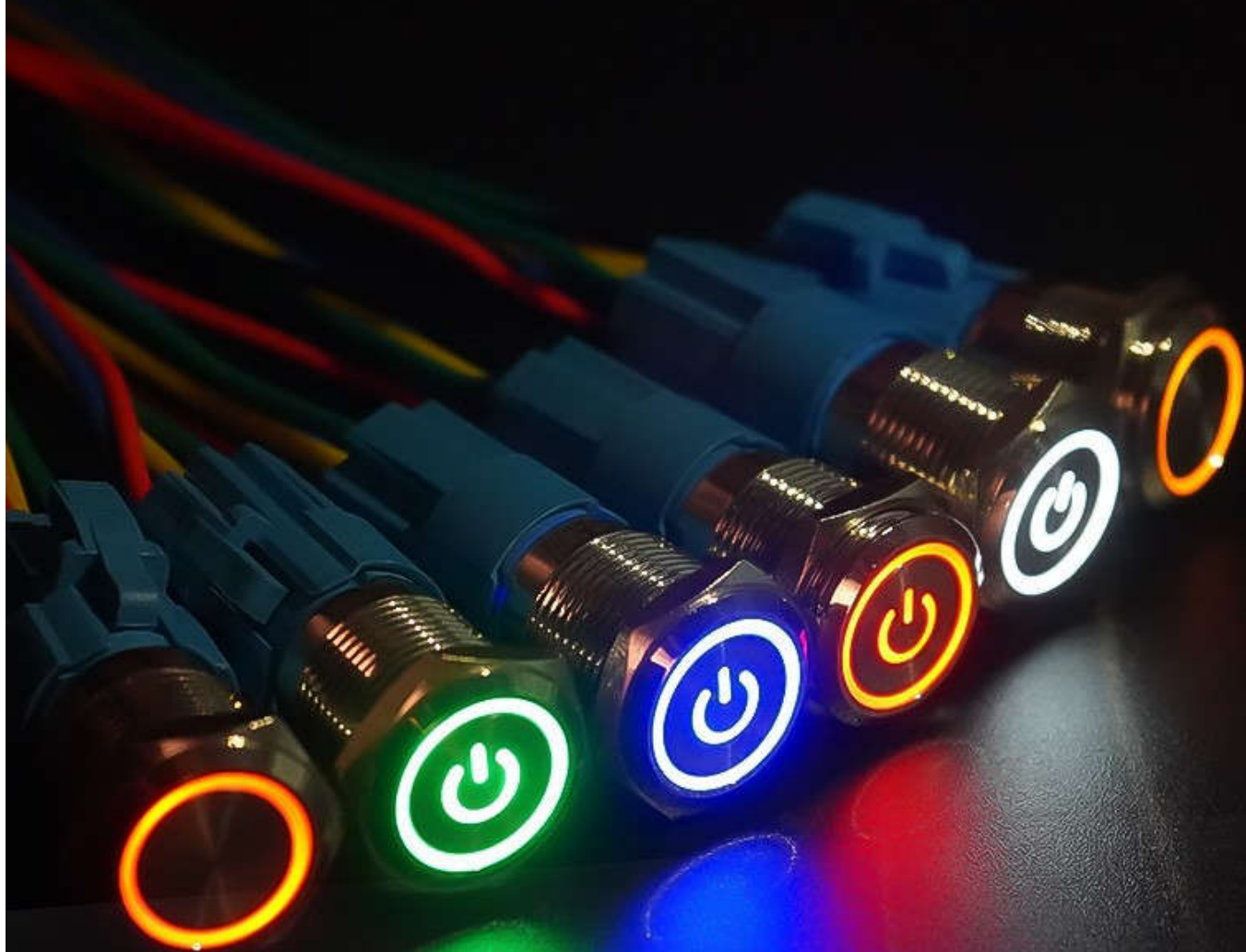

乐清市鸿怡电气厂

shop0919087950352.1688.com

















