

1008

Series

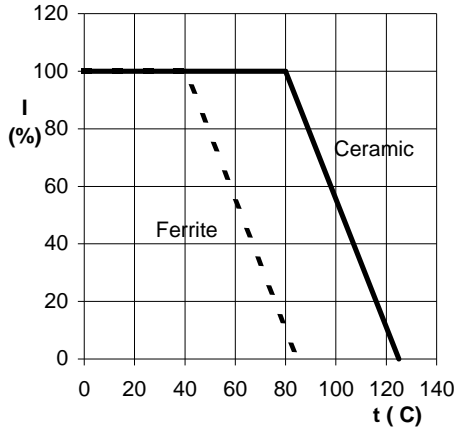

Current carrying capacity dependent on the ambient temperature

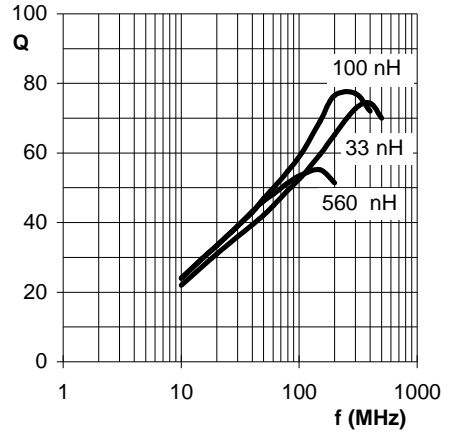

Typical Q - shape dependent on frequency

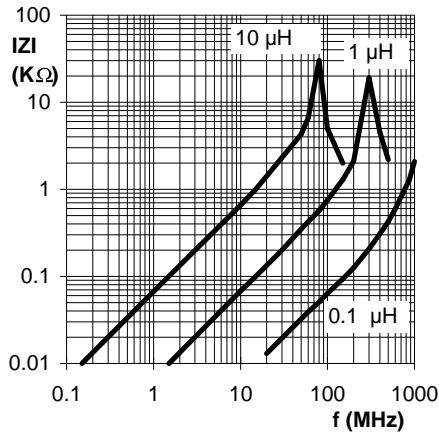

Impedance dependent on frequency

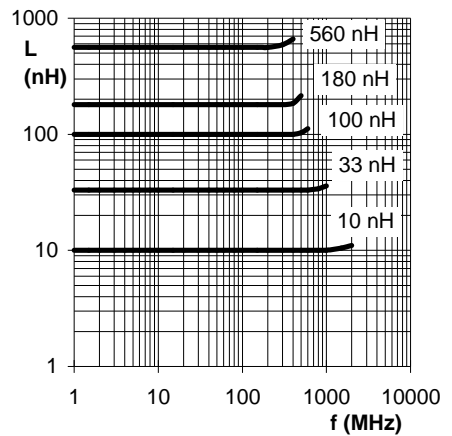

Inductance dependent on frequency

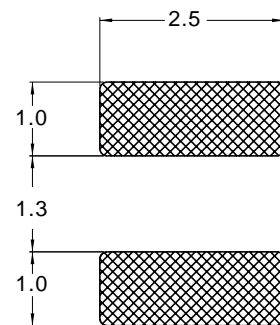
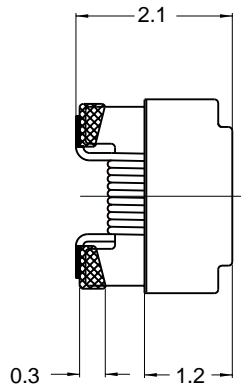
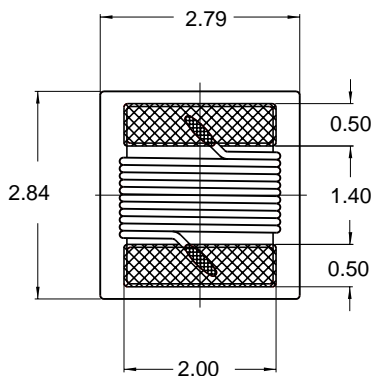

Recommended layout for solder pads



Series

1008

Ordering code	Inductance L (μH)	fL (MHz)	Tol. %	Q min.	fa (MHz)	SRF min (MHz)	DC Res. max (Ω)	Rated DC Current (mA)	Material
1008AS-4N7M-01	0.0047	50	± 20,10	15	500	6000	0.15	600	Ceramic
1008AS-8N2M-01	0.0082			25	1000	5000	0.08		
1008AS-010M-01	0.010			50	500	4100		0.09	
1008AS-012M-01	0.012					3300	0.10		
1008AS-015M-01	0.015			55	350	2500		0.09	
1008AS-018M-01	0.018					2400	0.12		
1008AS-022M-01	0.022			60	350	1600		0.13	
1008AS-027M-01	0.027					1500	0.14		
1008AS-033M-01	0.033			65	350	1300		0.15	
1008AS-039M-01	0.039					1500	0.16		
1008AS-047M-01	0.047	60	350	1000	0.22				
1008AS-056K-01	0.056			950		0.56			
1008AS-068K-01	0.068	60	350	850	0.63				
1008AS-082K-01	0.082			750		0.70			
1008AS-R10K-01	0.10	60	350	700	0.77				
1008AS-R12K-01	0.12			600		0.91			
1008AS-R15K-01	0.15	65	350	570	1.05				
1008AS-R18K-01	0.18			450		1.12			
1008AS-R22K-01	0.22	45	100	450	1.19				
1008AS-R27K-01	0.27			415		1.33			
1008AS-R30K-01	0.30	45	100	375	1.40				
1008AS-R33K-01	0.33			360		1.47			
1008AS-R39K-01	0.39	50	50	350	1.54				
1008AS-R47K-01	0.47			320		1.61			
1008AS-R51K-01	0.51	28	50	290	1.68				
1008AS-R56K-01	0.56			250		1.75			
1008AS-R62K-01	0.62	20	7.9	200	1.85				
1008AS-R68K-01	0.68			160		2.0			
1008AS-R75K-01	0.75	22	25	140	2.3				
1008AS-R82K-01	0.82			110		2.6			
1008AS-R91K-01	0.91	18	7.9	100	2.8				
1008AS-1R0K-01	1.00			90		4.8			
1008AS-1R1K-01	1.10	20	7.9	80	5.1				
1008AS-1R2K-01	1.20			60		5.4			
1008AS-1R5K-01	1.50	18	7.9	25	6.0				
1008AS-1R8K-01	1.80			40		6.6			
1008AS-2R2K-01	2.20	18	7.9	25	6.5				
1008AS-2R7K-01	2.70			170		7.5			
1008AS-3R3K-01	3.30	18	7.9	25	8.4				
1008AS-3R9K-01	3.90			110					
1008AS-4R7K-01	4.70	18	7.9	25	8.4				
1008AS-5R0K-01	5.00			110					
1008AS-5R6K-01	5.60	18	7.9	25	8.4				
1008AS-6R8K-01	6.80			40					
1008AS-8R2K-01	8.20	18	7.9	25	8.4				
1008AS-100K-01	10.0			40					

Sample Kits available:

each 10 pcs. per value tolerance ± 5% Order no. **SK 1008AS/F; 5%**
Tighter tolerance and individual sample kits on request



1008

Series

Ordering Code	Inductance	f _L	Tol.	Q	f _Q	SRF	DC Res.	Rated DC Current	Material
	L (μH)	(MHz)	%	min.	(MHz)	min (MHz)	max (Ω)	(mA)	
1008F-1R0K-01	1.00	7.9	± 10,5	15	7.9	190	0.32	500	Ferrite
1008F-1R2K-01	1.20			210		0.68	650		
1008F-1R5K-01	1.50			190		0.76	630		
1008F-1R8K-01	1.80			170		0.84	600		
1008F-2R2K-01	2.20			150		1.10	520		
1008F-2R7K-01	2.70			135		1.28	490		
1008F-3R3K-01	3.30			120		1.46	450		
1008F-3R9K-01	3.90			105		1.56	420		
1008F-4R7K-01	4.70			90		1.68	400		
1008F-5R6K-01	5.60			80		1.82	380		
1008F-6R8K-01	6.80			70		2.00	360		
1008F-8R2K-01	8.20			65		2.65	330		
1008F-100K-01	10.00			60		2.95	300		
1008F-150K-01	15.00			35		5.00	260		
1008F-220K-01	22.00			30		6.80	200		
1008F-330K-01	33.00	27	8.90	180					
1008F-470K-01	47.00	20	11.00	150					